

BZ

bezaresusa

PTO 1200 SERIES

SAE "A" 2 BOLT

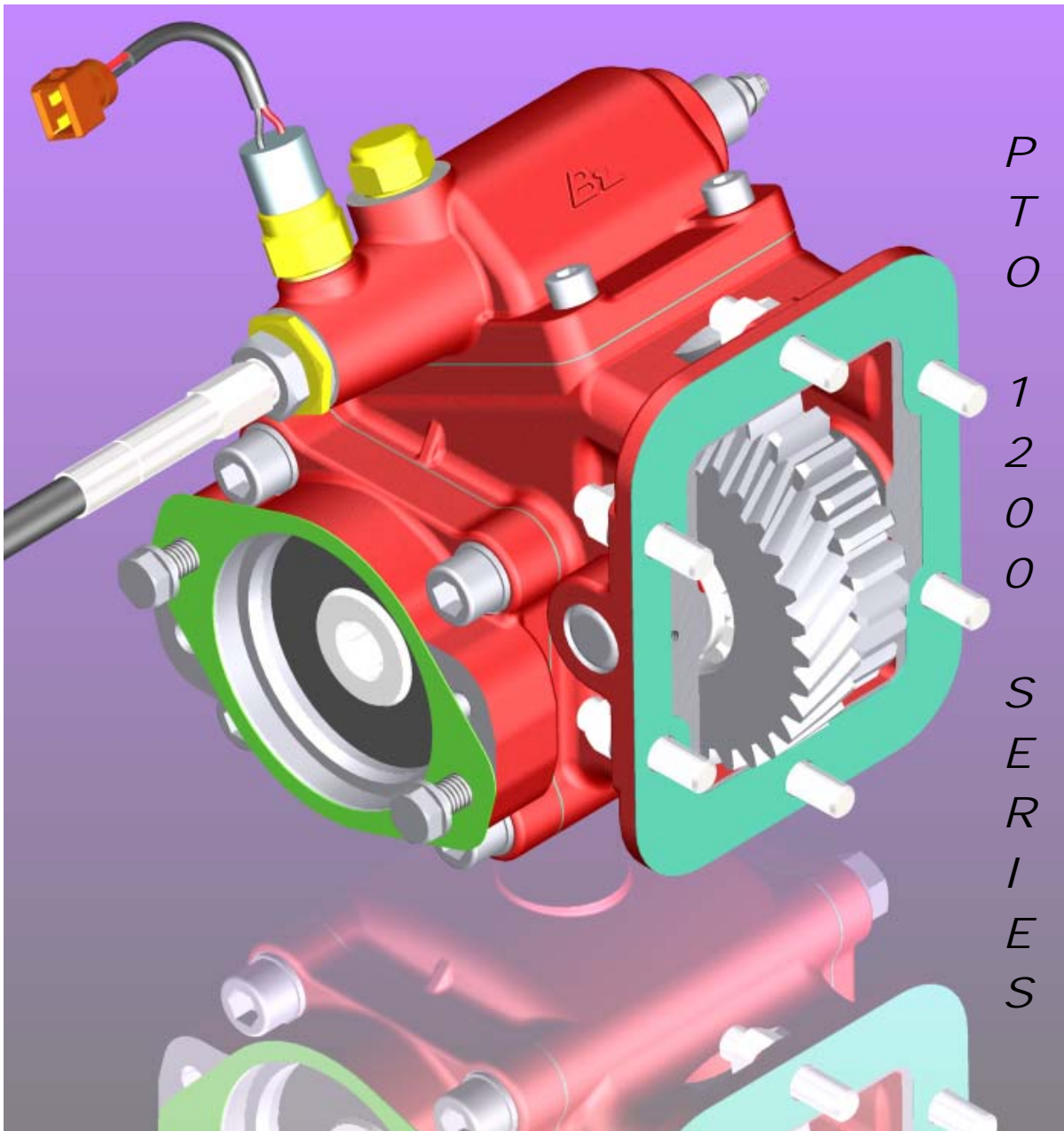

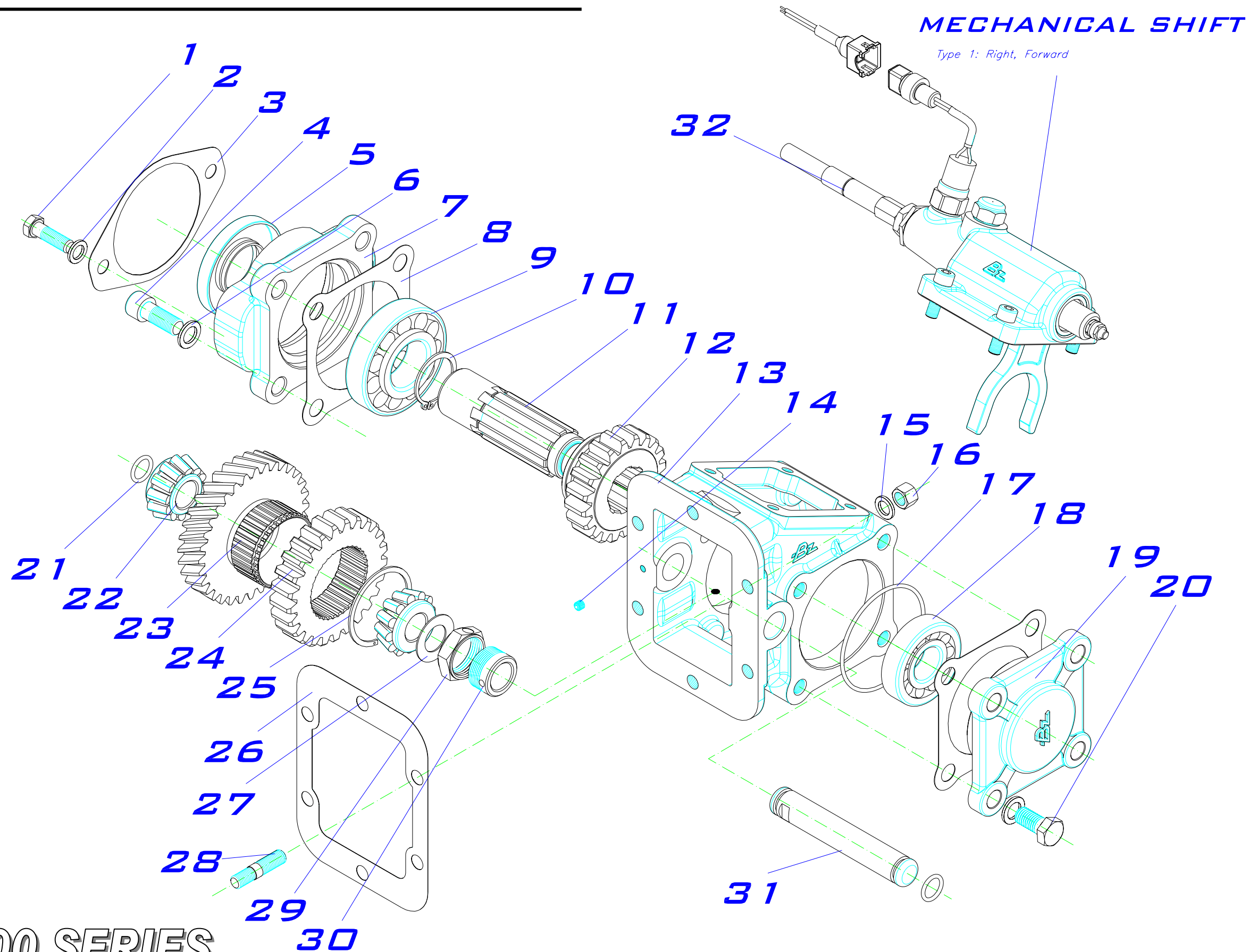

PTO 1200 SERIES
SAE "A" 2 BOLT

PTO 1200 Series SAE "A" 2 Bolt

ITEM	QT.	DESCRIPTION	DIMENS.	CODE	BZ USA Part #
1	2	Screw DIN 931, Hex head.	3/8"UNCx32	116020035	CS035
2	2	Washer DIN 125.	Ø10,5x21x2	102010003	WA003
3	1	Gasket.		108010113	GA113
4	4	Screw DIN 912 8.8 sealed.	M12x30	116010030	CS030
5	1	Oil seal BA SL	35 x 72 x 10	112010007	SE007
6	8	Washer DIN 125	12.5 x 20 x 2	102090009	WA009
7	1	Hosing flange, open end.		202130451	FL451
8	2	Gasket.		108010038	GA4015EC
9	1	Conical bearing 30305 A	25 x 62 x 18.25	113300003	RB003
10	1	Snap ring DIN 471	Ø 35	101010005	SR005
11	1	Output shaft.		Table 1	TABLE 1
12	1	Bottom gear		Table 2	TABLE 2
13	1	Housing 6 hole.		202013355	HS1200
14	1	Stud DIN 913.	M6 x 6	117010008	ST008
15	6	Washer DIN 125	10.5 x 16.8 x 2	102090010	WA010
16	6	Special hex nut	M10-100	119010001	NU001
17	1	O-ring	75 x 2.5	107010093	OR093
18	1	Conical bearing 30307A	35 x 80 x 22.75	113300004	RB004
19	1	Cover, closed end		208010931	EC931
20	4	Screw DIN 933 8.8 hex head.	M12x25	116030011	CS011
21	2	O-ring (VITON)	15 x 2.5	107100030	OR022
22	2	Conical bearing 32304 A	20 x 52 x 22.25	113300023	RB023
23	1	Input gear.		201029311	69
24	1	Upper gear		Table 3	TABLE 3
25	1	Snap ring WRE	Ø 55	101100001	SR001
26	*	Gasket 6 bolt	Spe = 0.5 mm	108010004	GA6015
	*	Gasket 6 bolt	Spe = 0.3 mm	108010102	GA6010
	*	Gasket 6 bolt	Spe = 1 mm	108010103	GA6032
27	1	Axial disc AS 2035.	20x35x1	114010008	WA008
28	6	Stud L=42 mm	M10(20-1/17-1.5)	117020072	ST072
29	1	Adjusting nut		200014851	PN851
30	1	Adjusting bush		200014841	PN841
31	1	Idler shaft, standard		203042531	IP531
32	1	Integral cable.	L= 98"	9014413	LV4413
	1	Integral cable.	L= 118"	9014613	LV4613

PTO 1200 Series SAE "A" 2 Bolt

TABLE 1 OUTPUT SHAFT

<i>OUTPUT SHAFT.</i>	<i>REF.</i>	<i>CODE.</i>	BZ USA Part #
<i>OUTPUT SHAFT PTO 1200 SAE A Z=9.</i>	<i>E/407</i>	<i>203024071</i>	OS071
<i>OUTPUT SHAFT PTO 1200 SAE AA Z=11.</i>	<i>E/551</i>	<i>203025511</i>	OS511
<i>OUTPUT SHAFT PTO 1200 SAE B Z=13.</i>	<i>E/549</i>	<i>203025491</i>	OS491

TABLE 2 PTO RATIO GEAR SET

RATIO	CODE	BOTTOM GEAR	UPPER GEAR Z=35
RATIO "C": 73%	<i>800534</i>	<i>R/687</i>	<i>R/686</i>
RATIO "E": 80%	<i>800634</i>	<i>R/654-1</i>	<i>R653-2</i>
RATIO "J": 95%	<i>800734</i>	<i>R/656-1</i>	<i>R/655-2</i>
RATIO "O": 125%	<i>800834</i>	<i>R/658-1</i>	<i>R/657-2</i>
RATIO "R": 137%	<i>801334</i>	<i>R/730</i>	<i>R/729</i>
RATIO "S" 150%	<i>801434</i>	<i>R/732</i>	<i>R/731</i>
RATIO "T": 165%	<i>800934</i>	<i>R/660-1</i>	<i>R/659-2</i>